

Sample Pollinator Gardens

The following garden plans are designed planting in **full sun** (minimum of 6 hours), with morning sun being more desirable than afternoon sun, if possible.

Caterpillar Food Sources

In addition to milkweed for monarchs, must provide host plants for at least 5 additional butterfly or moth species.

1. Milkweed - Monarchs (and Queens in south GA)
2. Aster - Pearl Crescent
3. Parsley - Black Swallowtail
4. Passionvine - Gulf Fritillary and Variegated Fritillary (and Zebra Longwings in south GA)
5. Purple Coneflower - Silvery Checkerspot
6. Wild Indigo - Wild Indigo Duskywing

Pollinator Nectaring Sources

Must provide 4 plants that bloom in the spring, 4 plants that bloom in the summer, and 4 plants that bloom in the fall.

Spring

Coreopsis
Crimson Clover
Verbena
Wild Indigo

Summer

Agastache
Milkweed
Parsley
Passionvine
Purple Coneflower

Fall

Aster
Goldenrod
Joe Pye Weed
Pineapple Sage

Rectangular Garden Design - for at least a 13' by 6' plot

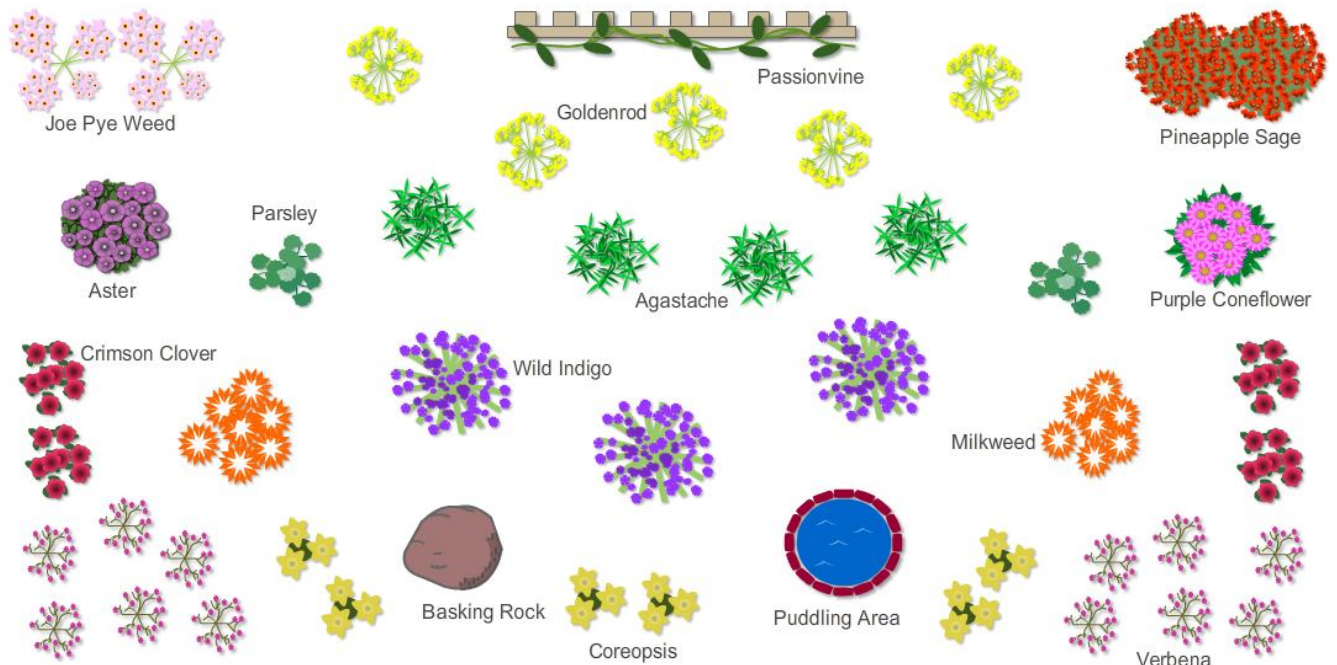

Corner Garden Design - for a plot with at least 11' sides

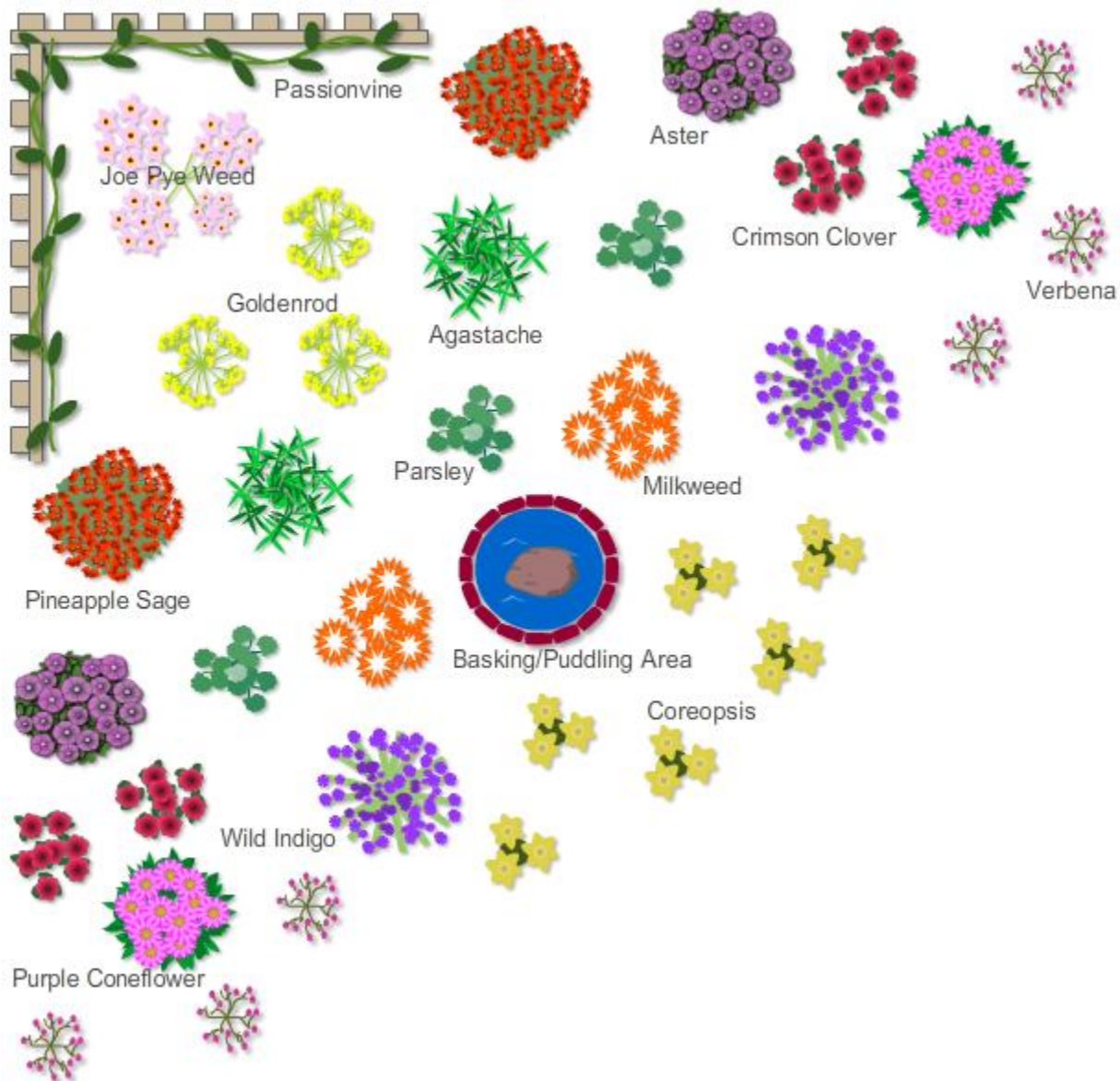

Garden Tips:

Crimson Clover (*Trifolium incarnatum*) and Larkspur (*Consolida ambigua*), which may be used as a substitute, are annuals usually sold as seeds instead of container-grown plants. They are both best planted from seeds in the fall. Crimson Clover is commonly grown as a cover crop and is often available at hardware stores, feed-and-seed stores, or garden centers. After blooming, it will die off but will likely reseed itself. It may also “move around” to fill in any available gaps in the garden.

Parsley (*Petroselinum crispum*) is a biennial and will bloom during its second year. It may return from seed on its own or may need to be replaced every two years by purchasing transplants.

Pineapple Sage (*Salvia elegans*) is considered a tender perennial in north Georgia. A layer of mulch will help protect it over the winter.

Taller varieties of Joe Pye Weed (*Eupatorium purpureum*) and Goldenrod (*Solidago* spp) may benefit from staking to prevent them from falling over. Or, they may be cut back (not all the way to the ground) earlier in the growing season to help create shorter sturdier plants.

Passionvine (*Passiflora incarnata*) climbs by tendrils and will need a trellis for support. It may need a little “training” to keep it on the trellis instead reaching out to also grow on the other plants in the garden.

Milkweeds support an entire community of insects and will likely attract small yellow aphids throughout the growing season as well as orange and black milkweed bugs as seed pods begin to form. Tussock moth caterpillars may also be found feeding in large groups. *Milkweed, Monarchs and More: A Field Guide to the Invertebrate Community in the Milkweed Patch* is an excellent book for helping to identify other interesting members of the Milkweed community.

Silvery Checkerspots overwinter as caterpillars so be careful not to do too much clean-up around the bases of Purple Coneflowers.

Puddling areas may be created using most any type of container that holds water including flower pot saucers, trash can lids, etc. Bury the container to the top of its rim, then fill it with a combination of small rocks plus sand or garden soil. Adding compost or composted manure can make the spot even more appealing by adding minerals.

Basking areas can be made by placing a flat rocks in a sunny patch of the garden or even in the puddling area. These rocks can also make nice stepping stones for the gardener and reduce soil compaction by keeping feet out of other areas where plants are growing. A log can also make a great basking spot.

A layer of mulch in the garden will help conserve soil moisture and suppress weeds.

Removing spent flowers, called deadheading, can encourage more blooms. Don't remove all spent flowers from the plants you want to produce seeds though!